

BELOW ROAD SURFACE  
TYPE 1

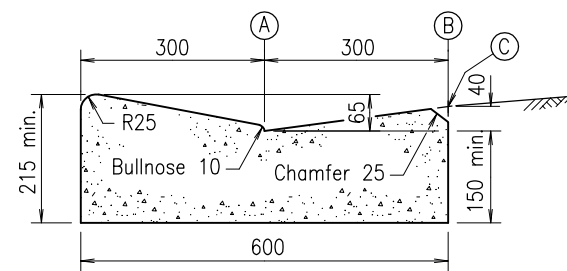

WITH CHANNEL  
TYPE 2

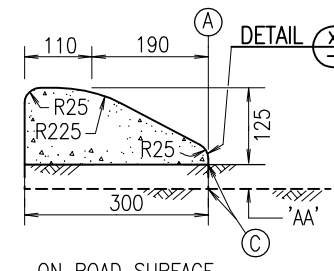
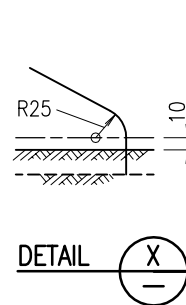

ON ROAD SURFACE  
TYPE 8 (DEPTH 125)  
TYPE 9 (DEPTH 125 + 'AA')

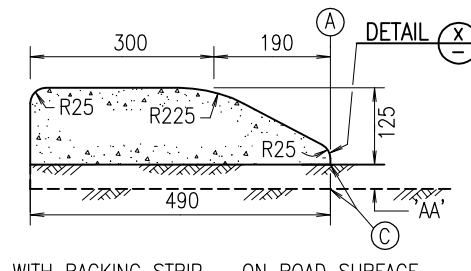

WITH BACKING STRIP - ON ROAD SURFACE  
TYPE 10 (DEPTH 125)  
TYPE 11 (DEPTH 125 + 'AA')

'AA' See note 4

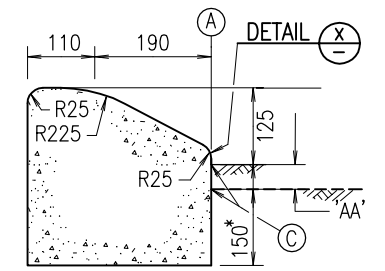

BELOW ROAD SURFACE  
TYPE 12 (DEPTH 125)  
TYPE 13 (DEPTH 125 + 'AA')

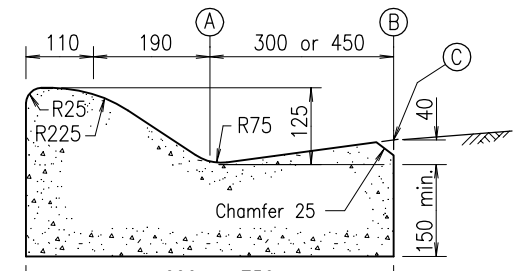

WITH CHANNEL  
TYPE 14 (300 CHANNEL)  
TYPE 15 (450 CHANNEL)

## MOUNTABLE KERB

## SEMI MOUNTABLE KERB

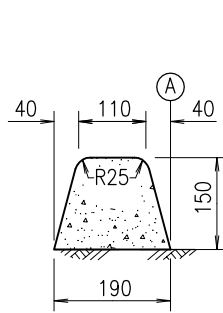

ON ROAD SURFACE  
TYPE 4

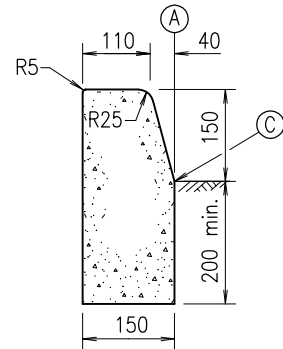

BELOW ROAD SURFACE  
TYPE 5  
BARRIER KERB

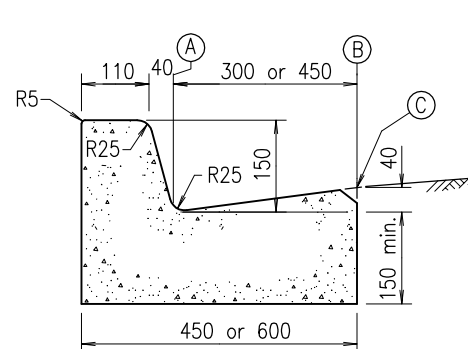

WITH CHANNEL  
TYPE 6 (300 CHANNEL)  
TYPE 7 (450 CHANNEL)

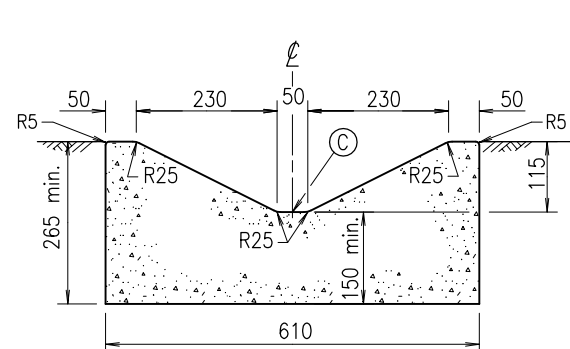

TYPE 3  
CHANNEL

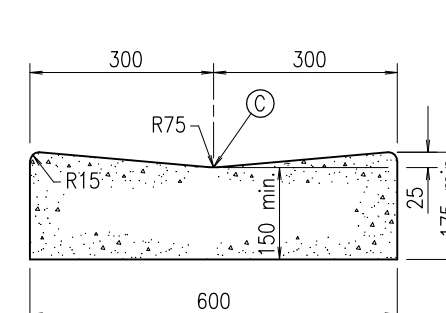

TYPE 22  
CHANNEL

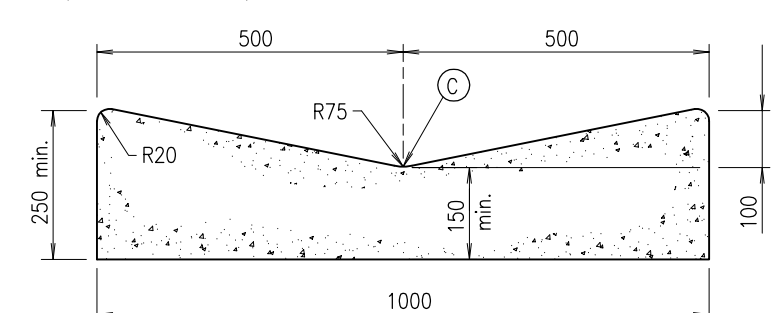

TYPE 28  
CHANNEL

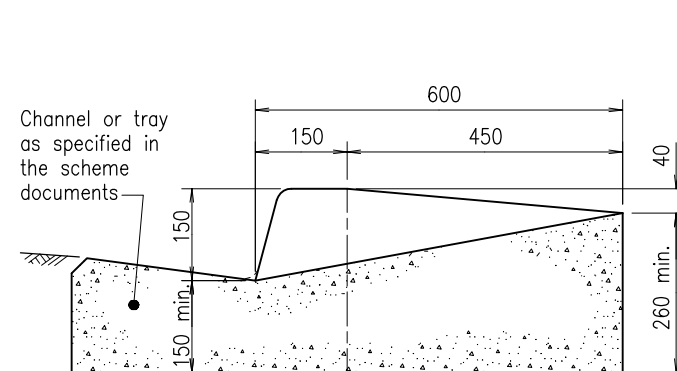

SECTION 2

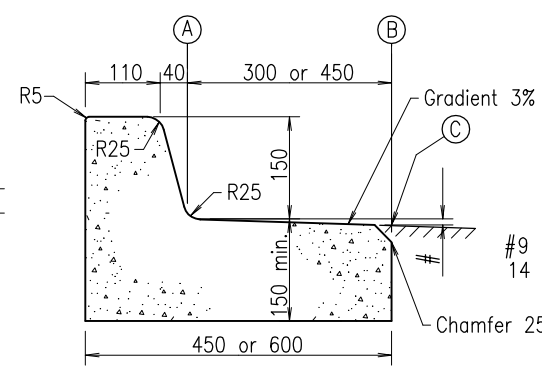

TYPE 23 (300 TRAY)  
TYPE 24 (450 TRAY)  
BARRIER KERB AND TRAY

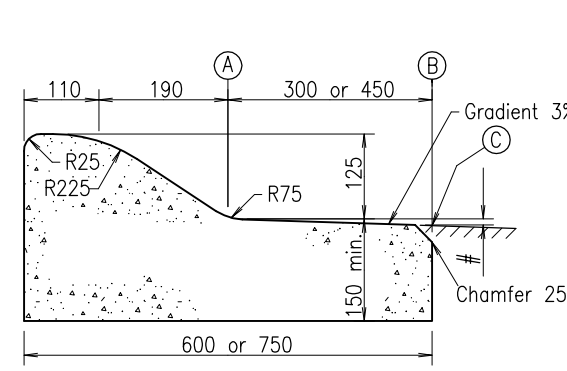

TYPE 25 (300 TRAY)  
TYPE 26 (450 TRAY)  
SEMI MOUNTABLE KERB AND TRAY

## REFERENCE POSITIONS

- (A) Line of kerb
- (B) Line of channel lip
- (C) Height reference

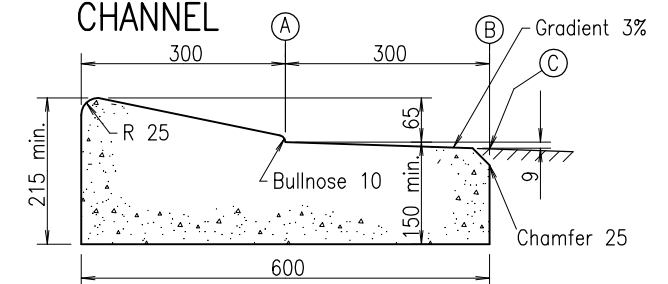

TYPE 27  
MOUNTABLE KERB AND TRAY

## NOTES :

1. CHANNEL THROAT THICKNESS of 150mm and portion of kerbs below finished surface shown is a minimum. The underside of the section should preferably coincide with the top of a pavement layer in level and slope.
2. TRANSITIONING between kerb types to be carried out over 5m.
3. CONCRETE to be Grade N32/10.
4. ASPHALT ALLOWANCE 'AA' provides for initial asphalt layer and/or future overlay as indicated in the documents. 'AA' may include the thickness of any combination of: - asphalt corrector course - initial asphalt layers - estimated future asphalt overlay
5. DETAILS TO BE SHOWN ELSEWHERE IN THE DOCUMENTS :  
Width of vehicle crossing 'W' (if not standard), kerb type, kerb with channel type, kerb with tray type and channel type.
6. RAMPED PEDESTRIAN CROSSING TYPES 18 to 21 are shown on Standard Drawing 1446.
7. DIMENSIONS in millimetres unless shown otherwise.

## ASSOCIATED DOCUMENTS :

Department of Main Roads Manual of Standard Drawings Roads  
Department of Main Roads Manual of Standard Specifications Roads

## REFERENCED DOCUMENTS :

Standard Drawings :  
1446 Kerb Ramp - Ramped Pedestrian Crossing  
Standard Specifications :  
Drainage, Retaining Structures and Protective Treatments  
Australian Standards :  
AS 2876 Concrete Kerbs and Channels (Gutters) - Manually or Machine Placed

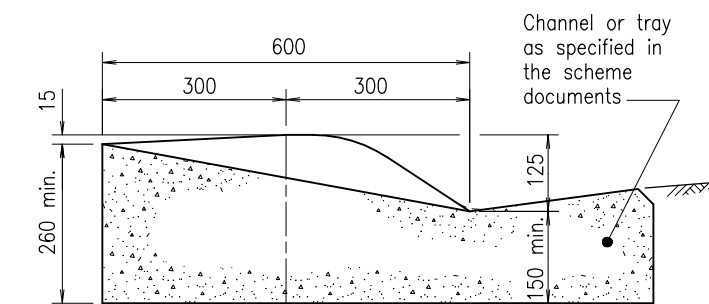

SECTION 3

TYPE 16 (300 CHANNEL OR TRAY)  
TYPE 17 (450 CHANNEL OR TRAY)

## RAMPED VEHICULAR CROSSING

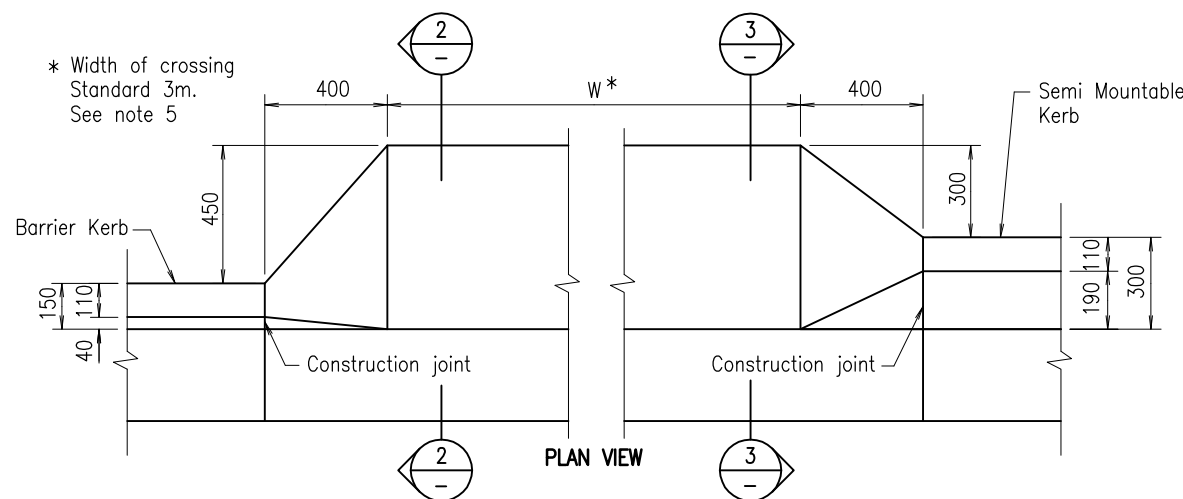

## RAMPED VEHICULAR CROSSING

KERB AND CHANNEL		Queensland Government Department of Main Roads	
KERBS, CHANNELS AND RAMPED VEHICULAR CROSSING	Size A3	Drawing No	
	Scales as shown	1033	
		Date 10/05	
		F	G H I J